



**COMPOSITE COMPUTER REGISTER
UNDER LAND TRANSFER ACT 1952**



R. W. Muir
Registrar-General
of Land

Search Copy

Identifier **NA23B/165**
Land Registration District **North Auckland**
Date Issued 21 December 1972

Prior References

NA918/210

Estate Fee Simple - 1/3 share
Area 933 square metres more or less
Legal Description Part Lot 1 Deposited Plan 19127

Proprietors

Benjamin William Fernyhough

Estate	Leasehold	Instrument	L 124922.4
		Term	999 years from and including 1.8.1972

Legal Description Flat 2 Deposited Plan 67583 and Garage
Deposited Plan 67583

Proprietors

Benjamin William Fernyhough

Interests

- Fencing Agreement in Transfer 45242 (Affects Fee Simple)
- 124922.3 Lease Composite CT NA23B/164 issued - 21.12.1972 (Affects Fee Simple)
- 124922.4 Lease of Flat 2 and Garage DP 67583 Term 999 years from and including 1.8.1972 Composite CT NA23B/165 issued - 21.12.1972 (Affects Fee Simple)
- 124922.5 Lease Composite CT NA23B/166 issued - 21.12.1972 (Affects Fee Simple)

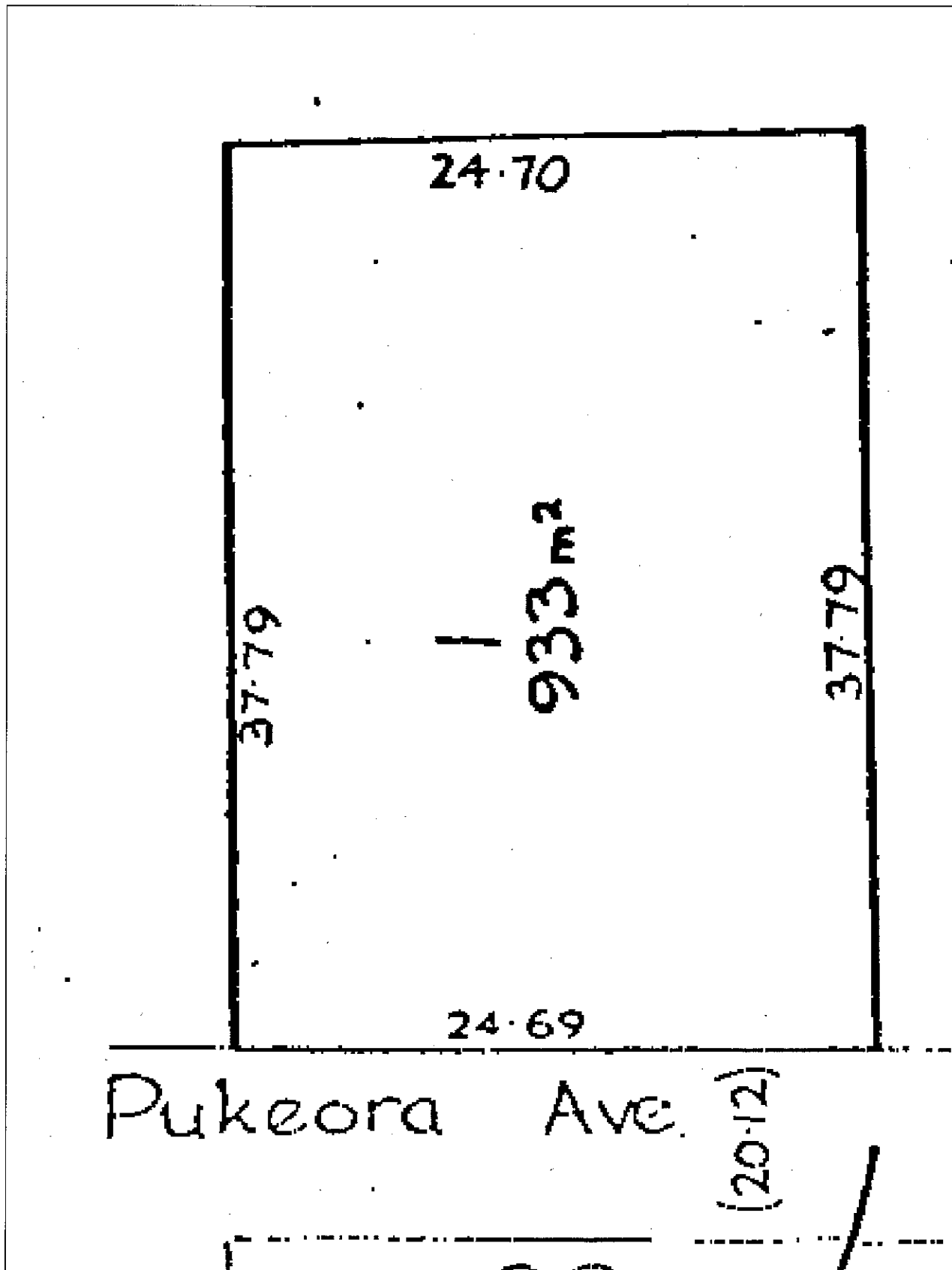

Land Transfer Office

Plan Number 07083
 Title Reference _____
 Land and Deeds Plan
 Firm _____ Fee _____
 Date _____ Abstract No. _____

Area coloured blue with Flat 1 subject to the right of user.
 Area coloured sepia with Flat 2 subject to the right of user.
 Area coloured yellow with Flat 3 subject to the right of user.

PLAN
 Name _____
 Firm M. C. Kinley & Son
 19 July 1972
 11 208
 A 011831

Deposited this 25th day
 of July 1972
 For Lease and Licence Purposes only

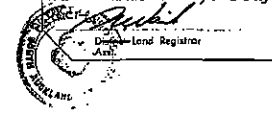

Pukekohe Avenue
 Scaled.
 Public Street Dedicated T.A.2176.
 (100)

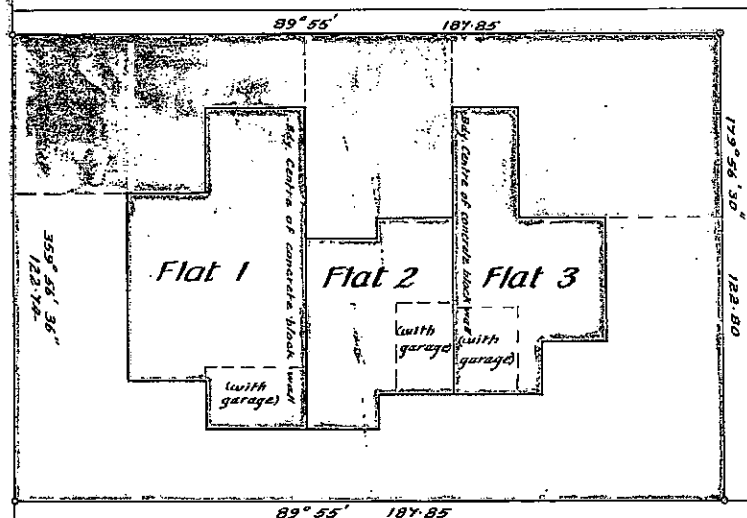

3
 D.P. 51767"

14
 D.P. 4169"

Boundaries of areas to be leased are the external face of walls unless otherwise stated.

Plan showing Flats on Pt. Lot 1 D.P. 19127, being Pt. Allot 163 of Sec. 16 Subs. of Auckland.

Approved for Lease and Licence Purposes only

Received _____
 Reference plans _____
 Field book _____
 Examined by ECB
 Recorded R. B. B.

Comprised in C.T. 918/210
 Survey Block & District 1. Ofakuhu
 Land District Nth. Auckland Local Body Auckland City Council
 Scale 20 links to an inch Surveyed by J. M. Kinley & Son Date April 1972
Jan Ferguson M. Kinley of Auckland Registered Surveyor, hereby certify that this plan has been made from surveys executed and information obtained by me, that the plan and survey thereof are correct and that the buildings are situated within the land to C.T. 918/210.

Approved
[Signature]
 Applicant or Registered Owner
 This space reserved for plan number

J. F. M. Kinley
 REGISTERED SURVEYOR
 DATE April 1972

67583